

Quick Start Guide

Pooli L1

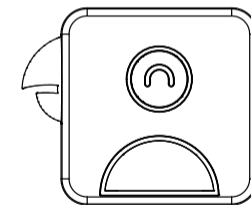

Content

Packing List	1
Appearance	2
Using Guide	3
Download APP	5
Connection	6
APP Setting	7
Disassemble	8
Replace Supplies	9
Official Supplies Types	10
Safety	11
FCC	12

Packing List

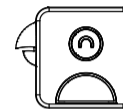

Pooli L1



Thermal Paper Roll

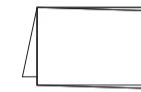

Quick Start Guide

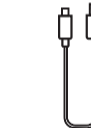

USB Cable

Note: The packing materials are actually based on the order.

Appearance

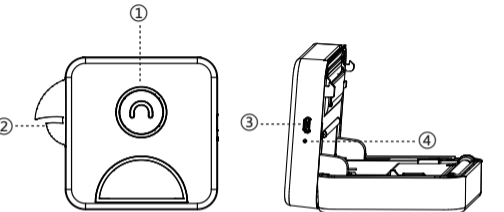

- ① Power button
- ② Parrot mouth accessory
- ③ USB Port
- ④ Reset button

Using Guide



Power Button Status

Hold down for 3 seconds to ON/OFF

- Lighting: Standby / Charging completed
- Notify Light slow flash: Charging / Updating
- Fast flash: Supplies near end, cover open, low battery, the print head is overheated



Charging

Use it for the first time after purchase

- Recommended to use after full charge
- For computer USB port charging only



USB Cable

In addition to the dedicated charger, you can also use the charging cable of mobile device.

- Recommended to use a dedicated charging cable to charge.
- It takes about 90 minutes to charge with 5V/1A.



Print Paper Purchase

From APP, Tmall, Jingdong Mall

- Official website (www.pooli.com)

Download APP

Scan the QR code below or search for "Pooli" in the app store to download and install the app. :



Official WeChat service :



Official Weibo service :



Connection

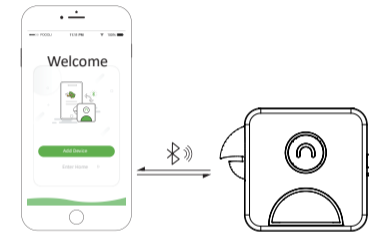

Register and log in to the app, click Add Device. Connect to the device by searching for Bluetooth or scan code.

-6-

APP Setting



Double click the power button
Print QR code

- Double click the power button to print the QR code.
- Add the Scanning function by APP, then connect the device by scanning QR code.



Bluetooth 4.0
Bluetooth pairing

- When the first connection succeeds, the next time you start the application that will connect Poooli L1 automatically.
- In the connection state, double click the power button to disconnect the connection.



Simple operation
APP setting

- You can view information such as remaining power, firmware versions in device management.

-7-

Disassembly

● Dismantle

If you want to remove the parrot mouth accessory, please according to the step take them down.



● Install

If you want to attach the parrot mouth accessory, use the magnet to adsorb the parrot mouth.

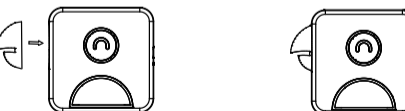

-8-

Replace Supplies

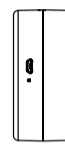

Figure 1



Figure 2

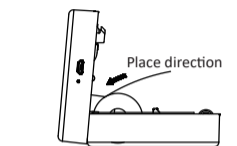

Figure 3

- Place Poooli as shown in figure 1, and look at the arrow.
- With reference to figure 2, push down the upper cover.
- When replacing supplies, place the supplies in reference to the direction shown in figure 3.
- If the supplies are properly placed, close the upper cover to the lower cover and push the upper cover back to its original shape.

⚠ When changing supplies, do not touch the print head in case of overheating.

-9-

Official Supplies Types

Self-adhesive Paper	With adhesive backing, cuttable size, can be preserved for 10 years
Ten-year Thermal Paper	Clear printing, stable color rendering, suitable for daily use, can be preserved for 10 years
Gray-scale Paper	Suitable for photo printing, waterproof, oil proof and scratch proof, can be preserved for 7 years
Label Paper	Stickers with adhesive backing, fixed size, can be preserved for 10 years
Affordable Thermal Paper	Affordable, suitable for text printing, can be preserved for 2 years

All Poooli paper does not contain bisphenol-A.

If the printer failure is caused by using other paper, you will not be able to enjoy the three guarantees policy.

-10-

Safety



Battery overheating
Battery management and cautions

- When the charge is completed, please unplug the charging line.
- To avoid fire, do not charge at high temperatures (e.g. sweating rooms, bonfire accessories, etc.).



Charger attention
Print head management and cautions

- There may be damage to the print head due to improper charging.
- We recommend not to use Poooli L1 in high humidity or dusty areas.



Combustion hazard
Print head overheating

- After printing, do not touch the print head directly to prevent burn.



Charging port damage phenomenon
Charging cautions

- Please gently insert or unplug the charging line to prevent excessive damage to the charging port.

-11-

FCC

This device complies with part 15 of the FCC Rules. Operation is subject to the following two conditions: (1) this device may not cause harmful interference, and (2) this device must accept any interference received, including interference that may cause undesired operation.

Any changes or modifications not expressly approved by the party responsible for compliance could void the user's authority to operate the equipment.

NOTE: This equipment has been tested and found to comply with the limits for a Class B digital device, pursuant to Part 15 of the FCC Rules. These limits are designed to provide reasonable protection against harmful interference in a residential installation. This equipment generates, uses and can radiate radio frequency energy and, if not installed and used in accordance with the instructions, may cause harmful interference to radio communications.

-12-

FCC

However, there is no guarantee that interference will not occur in a particular installation. If this equipment does cause harmful interference to radio or television reception, which can be determined by turning the equipment off and on, the user is encouraged to try to correct the interference by one or more of the following measures:

- Reorient or relocate the receiving antenna.
 - Increase the separation between the equipment and receiver.
 - Connect the equipment into an outlet on a circuit different from that to which the receiver is connected.
 - Consult the dealer or an experienced radio/TV technician for help.
- To maintain compliance with FCC's RF Exposure guidelines, This equipment should be installed and operated with minimum distance between 20cm the radiator your body: Use only the supplied antenna.

FCC ID: 2APWO-C1

-13-